

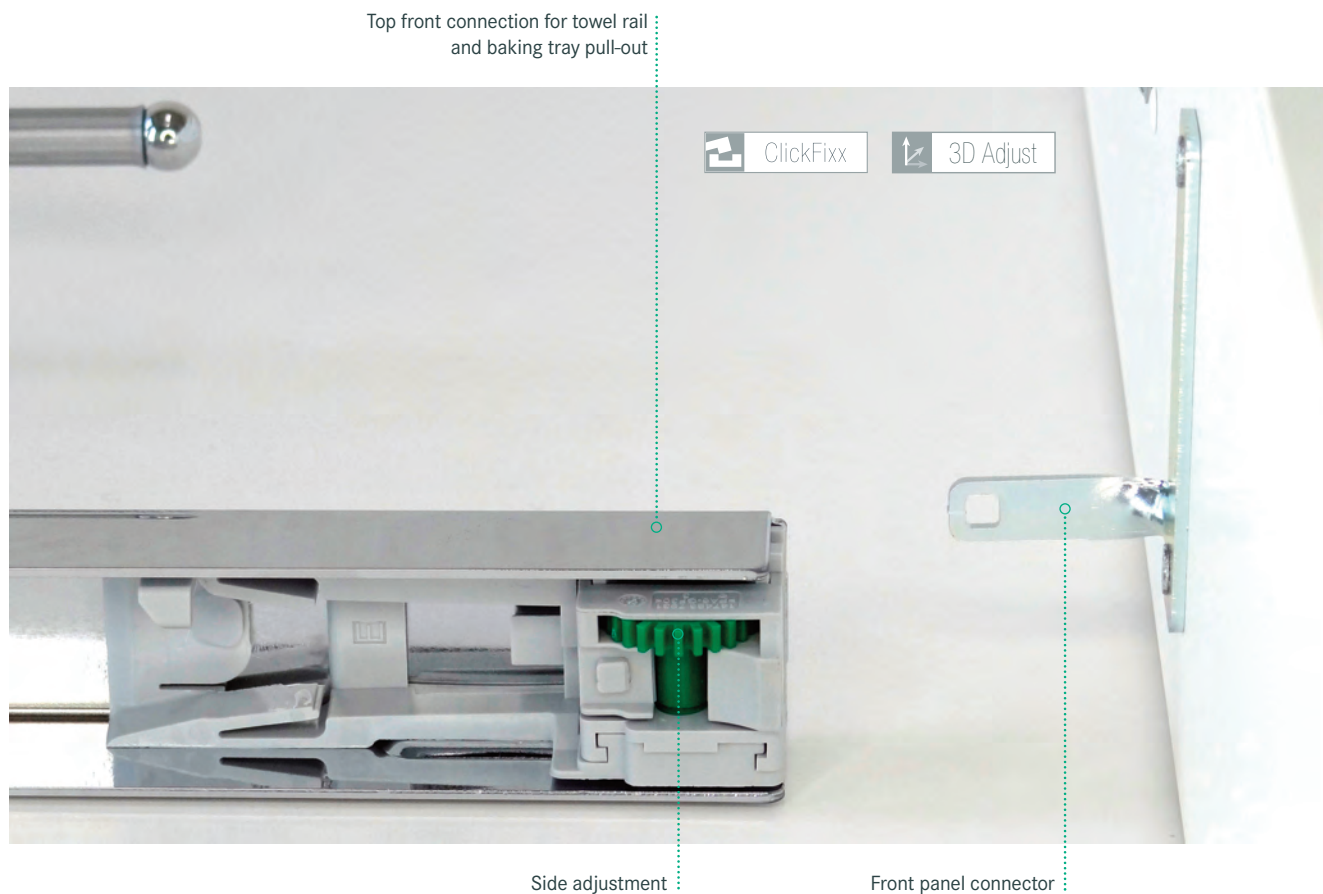

**No.15 – base unit pull-out** –  
makes great use of narrow gaps.



## no.15 – Ultra-slim pull-out with ClickFixx. Now with 3D front adjustment!

**Two interface** options for the 3D-X No.15 pull-out make for easy integration in any production process. The fitting can now either be clipped onto the runner without tools or connected using a front panel connector.

3D front adjustment makes adjustment ultra-simple.

### Product features

- ClickFixx clip-on connection for fitting and runner or fitting and front panel.
- Toolless 3D front adjustment
- Can be installed with or without front panel, SoftStopp Plus with self-closing
- Available for the 90° version of towel rail, baking tray holder and 2-tray No.15 pull-out.



Front panel connector

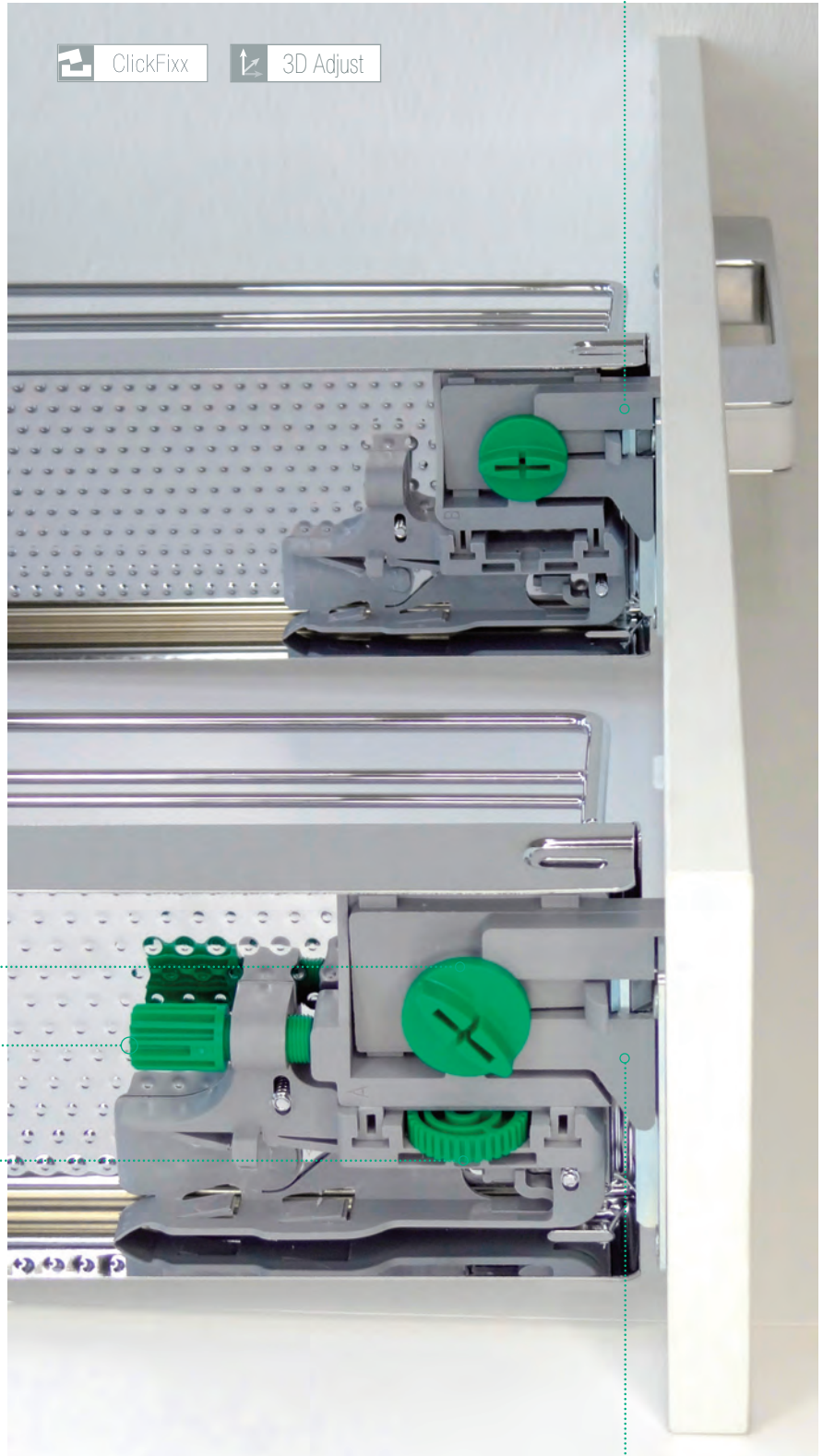

Top front connector  
for 2-tray pull-out

Side adjustment

Tilt adjustment

Height adjustment

## Toolless 3D front adjustment

Height and tilt are adjusted on the bottom front connector. The top front connector with its 'floating' bearing automatically keeps the connectors parallel when bottom connector height is changed.

Bottom front connector  
for 2-tray fitting and for towel rail  
and baking tray pull-out.



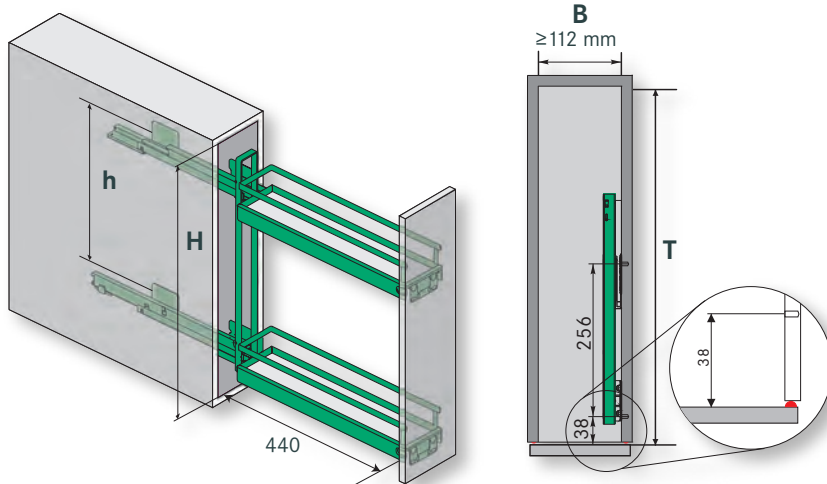

No.15 base unit pull-out, 90° front panel angle

	2 trays	3 trays
<b>B</b> = inside carcase width:	≥ 112 mm	≥ 112 mm
<b>T</b> = inside carcase depth:	≥ 481 mm	≥ 481 mm
<b>H</b> = inside carcase height:	≥ 542 mm	≥ 755 mm
<b>h</b> = hole distance:	380 mm	595 mm

Art. no.      Dimensions (mm)

for 90° unit  
attach right  
Maximum load:  
12 kg

**No.15 base unit pull-out, STYLE, 2 trays**  
Standard with **SOFTSTOPP** damping  
complete;  
incl. textured metal trays  
and full-extension runners

03 5412



05 5412      3D-X

